

| | | | | | |
|------|---------|-----------|--------------------|----------|---------|
| REV. | ECN NO. | LOCATIONS | DESCRIPTION | DATE | DESIGN |
| A1 | | | MODIFY SOME DETAIL | 03/13'20 | Johnson |

3D VIEW

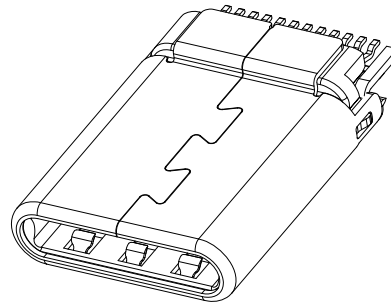
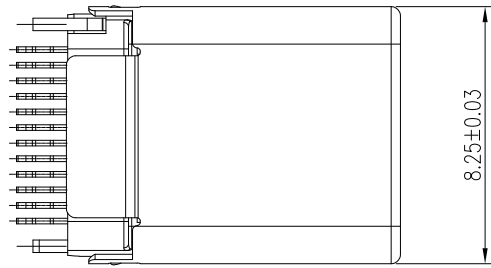

ORDERING INFORMATION

MCCM - C2D1 (XX T)

① ② ③

① PRODUCT SERIES:

USB C TYPE connector - Plug (Male) side.

② ITEM NO.:

Straddle Type/ Dual Row 24 pin
Stamping Shell/
Stacking Height 10.72mm.

CUSTOMER DRAWING

RoHS Compliant

③ GOLD PLATING :
01: 1u".

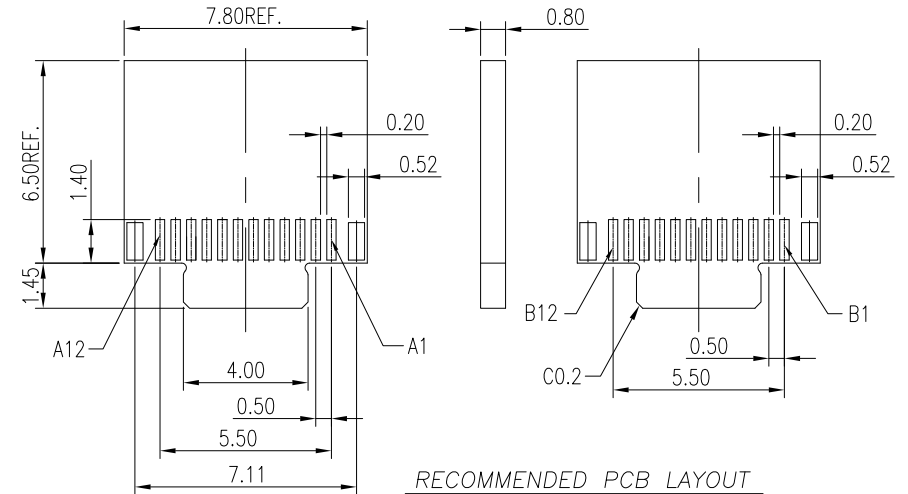

RECOMMENDED PCB LAYOUT
TOLERANCE: ±0.05

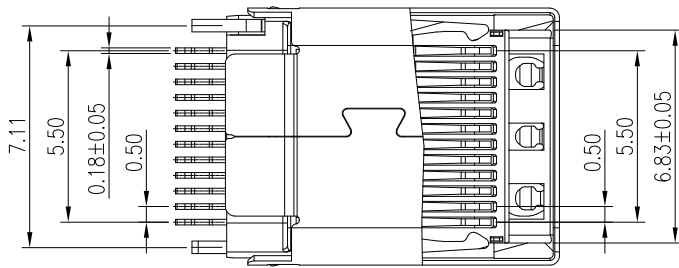
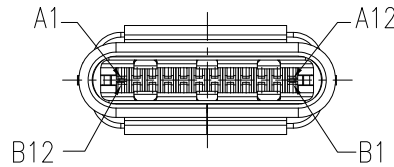
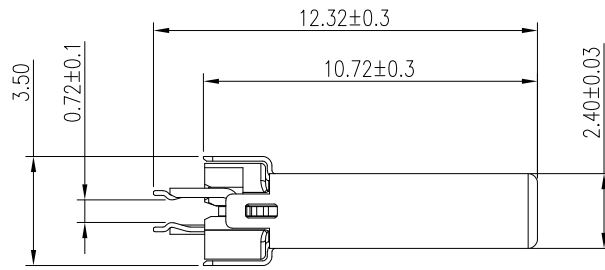

NOTES:

1. MATERIAL:

- (1) HOUSING: HIGH TEMP plastic, UL94 V-0.
- (2) CONTACT: COPPER ALLOY.
- (3) MID PLATE: STAINLESS STEEL.
- (4) SHELL: STAINLESS STEEL.

2. PLATED:

- (1) CONTACT: GOLD ON CONTACT AREA OVER NICKEL PLEATED OVERALL.
- (2) SHELL: NICKEL PLATED OVER ALL.
- (3) MID PLATE: CLEAR ONLY

| DIM | TOL |
|-------|-------|
| x.x | ±0.30 |
| x.xx | ±0.20 |
| x.xxx | ±0.10 |

| SUNFUN | | SUNFUN TECHNOLOGY LTD | | | |
|----------|---------------|-----------------------|----------|----------------|-----------------------------------------|
| DRAW NO. | MCCM-C2D1(A1) | DATE | 03/13'20 | MATERIAL: | SEE NOTES |
| DESIGN: | Johnson | 03/13'20 | FINISH: | SEE NOTES | DRAW NAME: |
| CHECK: | Johnson | 03/13'20 | FILE: | MCCF-C2D1(A1) | USB C Type CONN - MALE |
| REVIEW: | Rui | 03/13'20 | P/N: | MCCM-C2D1(XXT) | Straddle Type/ Dual Row 24 pin |
| APPROVED | Rui | 03/13'20 | REV. A1 | SCALE | Stamping Shell/ Stacking Height 10.72mm |
| | | | | | MODEL: USB C TYPE CONN |
| | | | | | UNIT: mm |
| | | | | | SHEET: 1/2 |

| REV. | ECN NO. | LOCATIONS | DESCRIPTION | DATE | DESIGN |
|------|---------|-----------|--------------------|----------|---------|
| A1 | | | MODIFY SOME DETAIL | 03/13'20 | Johnson |

CUSTOMER DRAWING

RoHS Compliant

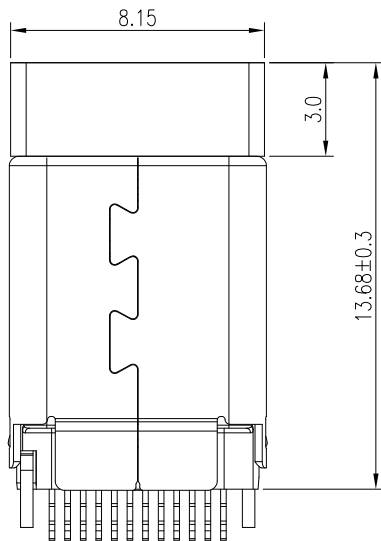
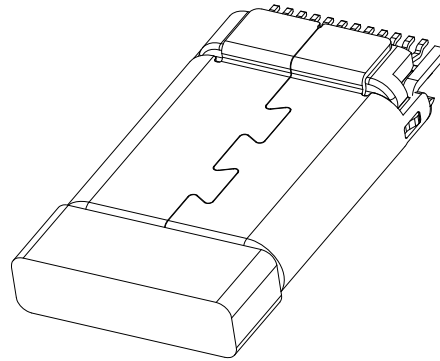
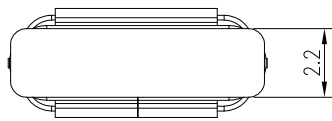

Plug will be packaged with the protection cap on.

USB TYPE-C PIN ASSIGNMENTS

| PIN NUMBER | SIGNAL NAME | PIN NUMBER | SIGNAL NAME |
|------------|-------------|------------|-------------|
| A1 | GND | B12 | GND |
| A2 | SSTXp1 | B11 | SSRXp1 |
| A3 | SSTXn1 | B10 | SSRXn1 |
| A4 | VBUS | B9 | VBUS |
| A5 | CC1 | B8 | SBU2 |
| A6 | Dp1 | B7 | Dn2 |
| A7 | Dn1 | B6 | Dp2 |
| A8 | SBU1 | B5 | CC2 |
| A9 | VBUS | B4 | VBUS |
| A10 | SSRXn2 | B3 | SSTXn2 |
| A11 | SSRXp2 | B2 | SSTXp2 |
| A12 | GND | B1 | GND |

| DIM | TOL |
|-------|-------|
| x.x | ±0.30 |
| x.xx | ±0.20 |
| x.xxx | ±0.10 |

| | | | | | |
|---------------|---------------|------------------------------|---------------------|-----------------------------------------|------------|
| SUNFUN | | SUNFUN TECHNOLOGY LTD | | | |
| DRAW NO. | MCCM-C2D1(A1) | DATE | MATERIAL: SEE NOTES | DRAW NAME: | |
| DESIGN: | Johnson | 03/13'20 | FINISH: SEE NOTES | USB C Type CONN - MALE | |
| CHECK: | Johnson | 03/13'20 | FILE: MCCF-C2D1(A1) | Straddle Type/ Dual Row 24 pin | |
| REVIEW: | Rui | 03/13'20 | P/N: MCCM-C2D1(XXT) | Stamping Shell/ Stacking Height 10.72mm | |
| APPROVED | Rui | 03/13'20 | REV. A1 | MODEL: USB C TYPE CONN | |
| | | | SCALE | UNIT: mm | SHEET: 2/2 |

