

REV.	ECN NO.	LOCATIONS	DESCRIPTION	DATE	DESIGN
A6			REVISED SOME DATA	06/25'19	Kyle

ORDERING INFORMATION

**MSMPS - SN2 (01T)**

- ① **PRODUCT SERIES**  
Mega SIM Card Socket  
With Switch Pin(normal close)  
Push Push Type.
- ② **ITEM NO.**  
2: Without Guide Post.

**CUSTOMER DRAWING**

RoHS Compliant

- ③ **GOLD PLATING**  
01: 1u"  
05: 5u"  
10: 10u"  
15: 15u"

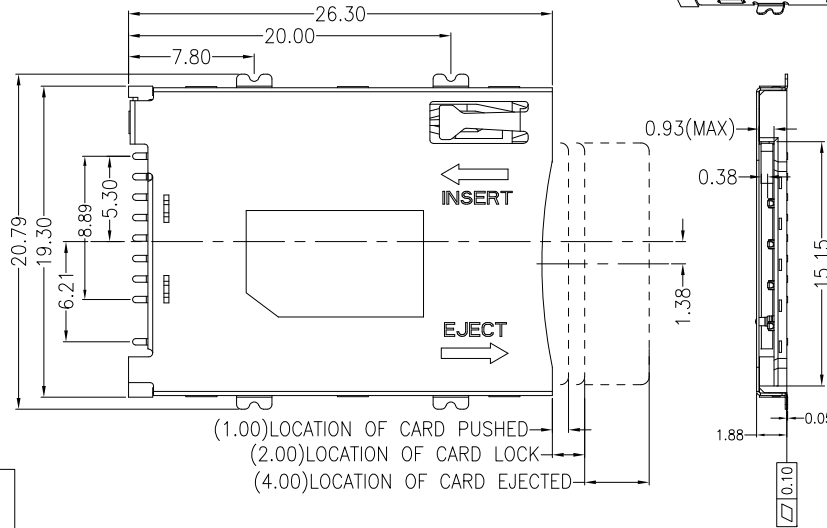
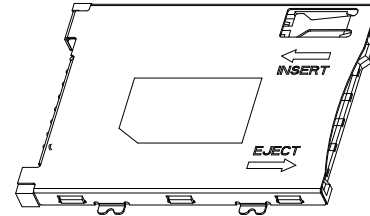

- (1.00)LOCATION OF CARD PUSHED  
(2.00)LOCATION OF CARD LOCK  
(4.00)LOCATION OF CARD EJECTED

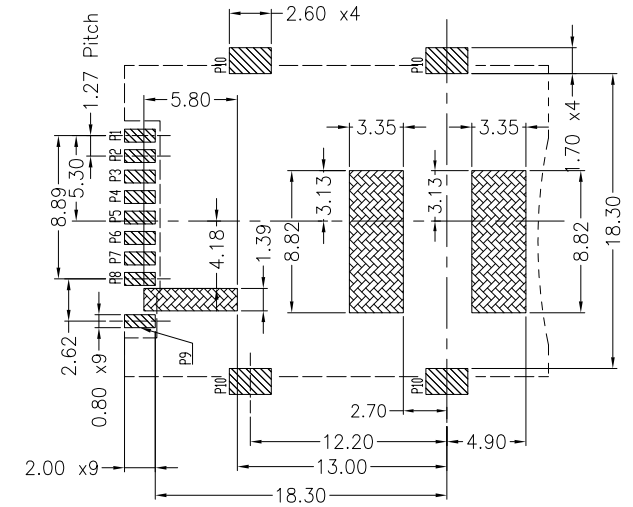

RECOMMENDED P.C.B HOLE LAYOUT  
COMPONENT SIDE VIEW(TOLERANCE: +/-0.05)

- Welding area
- Pattern Prohibited Area

NOTES:

- MATERIAL:**  
Insulator: High TEMP, UL 94V-0.  
Contact: Copper Alloy.  
Shell: Stainless Steel.
- PLATING:**  
Contact: Nickel underplated overall. Tin plated on solder tails. Gold plated on contact area.  
Shell: Nickel underplated overall.

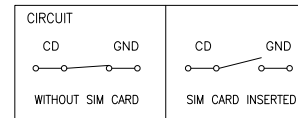

DIM	TOL
X.X	±0.38
X.XX	±0.25
X.XXX	±0.15

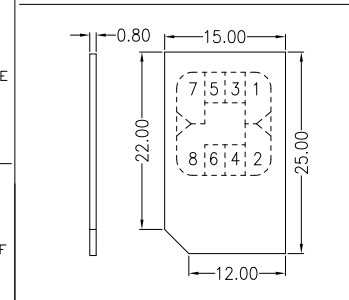

PIN NO.	NAME
P1	VCC
P2	GND
P3	RST
P4	VPP
P5	CLK
P6	I/O
P7	DATO
P8	MCMD
P9	CARD DETECT Switch
P10	GND

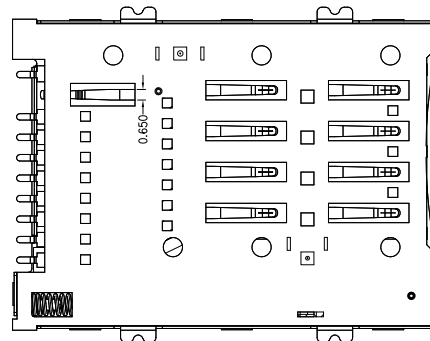

SUNFUN		SUNFUN TECHNOLOGY LTD			
DRAW NO.	MSMPS-SN2(A6)	DATE	MATERIAL: SEE NOTES	DRAW NAME:	
DESIGN:	Kyle	06/25'19	FINISH: SEE NOTES	SIM PP- 8+1PIN W/ SW(CLOSE) Standard/ 1.9mm H	
CHECK:	Kyle	06/25'19	FILE: MSMPS-SN2(A6)	MODEL: SIM CARD PP	
REVIEW:	Alex	06/25'19	P/N: MSMPS-SN2(XXT)	UNIT:	SHEET:
APPROVED	Alex	06/25'19	REV. A6 SCALE	mm	1/1